

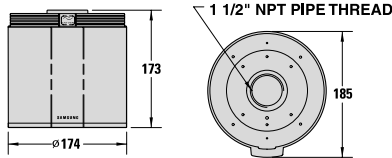









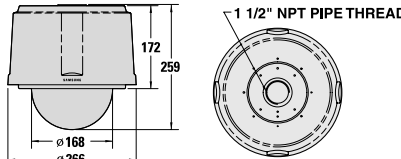

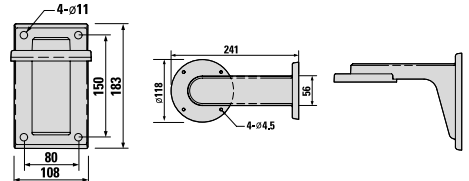
# SmartDome Camera Accessories

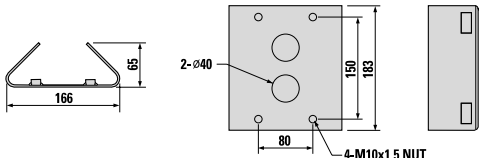
## Comparison Chart by Model

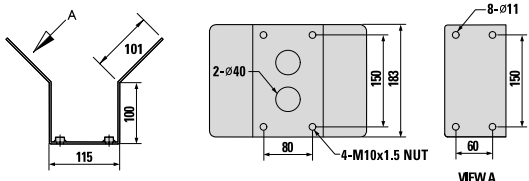
	<p><b>SHG-120 (Indoor Housing)</b></p> <p><b>Summary</b> SHG-120 is applied to the installation of Smartdome camera on the wall and ceiling.</p> <p><b>Features</b></p> <ul style="list-style-type: none"> <li>Aluminum Body</li> </ul>	<p><b>Dimension (unit :mm)</b></p> 
	<p><b>SHG-220 (Outdoor Housing)</b></p> <p><b>Summary</b> SHG-220 is applied to the installation of Smartdome camera outside the wall and ceiling. It was designed to tolerate harsh environment and earned IP 66 standards certification.</p> <p><b>Features</b></p> <ul style="list-style-type: none"> <li>Built-in Fan &amp; Heater</li> <li>Aluminum Body</li> <li>Clear Dome : high impact polycarbonate</li> <li>IP 66 Certification</li> </ul>	<p><b>Dimension (unit :mm)</b></p> 
	<p><b>SADT-100WM/101WM (Wall Mount Adaptor)</b></p> <p><b>Summary</b> SADT-100WM is applied when SHG-120 (Indoor housing) of SHG-220 (Outdoor housing) is installed on the outside/inside the wall. SADT-101WM is applied when SCC-931T (Anti-Vandal camera) is installed on the outside/inside the wall.</p>	<p><b>Dimension (unit :mm)</b></p> 
	<p><b>SADT-100PM (Pole Mount Adaptor)</b></p> <p><b>Features</b></p> <ul style="list-style-type: none"> <li>Indoor or Outdoor Applications</li> <li>Supports up to 88 Pounds(40Kg)</li> <li>Metal body</li> </ul>	<p><b>Dimension (unit :mm)</b></p> 
	<p><b>SADT-110CM (Corner Mount Adaptor)</b></p> <p><b>Features</b></p> <ul style="list-style-type: none"> <li>Indoor or Outdoor Applications</li> <li>Supports up to 97 Pounds(44Kg)</li> <li>Metal body</li> </ul>	<p><b>Dimension (unit :mm)</b></p> 
	<p><b>SADT-100CM (Ceiling Mount Adaptor)</b></p> <p><b>Features</b></p> <ul style="list-style-type: none"> <li>Metal body</li> <li>Indoor or Outdoor Applications</li> <li>Supports up to 70 Pounds(32Kg)</li> <li>Rugged Construction</li> </ul>	<p><b>Dimension (unit :mm)</b></p> 
	<p><b>SBR-100DCM (Ceiling Mount Bracket)</b></p> <p><b>Features</b></p> <ul style="list-style-type: none"> <li>Supports up to 35 Pounds(16Kg)</li> <li>Rugged Construction</li> <li>Metal body</li> </ul>	<p><b>Dimension (unit :mm)</b></p> 

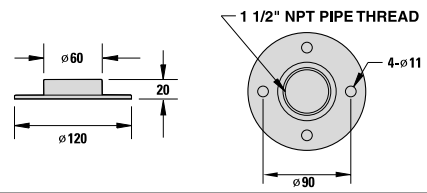
# SmartDome Camera Accessories

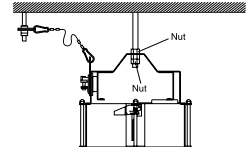
## Installation

### SHG-120

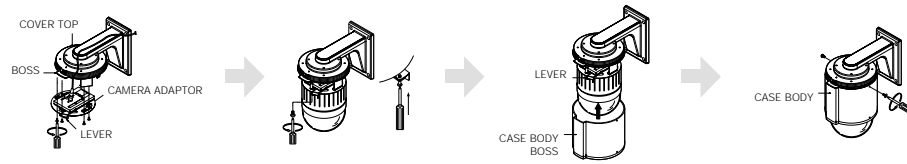

### SHG-220

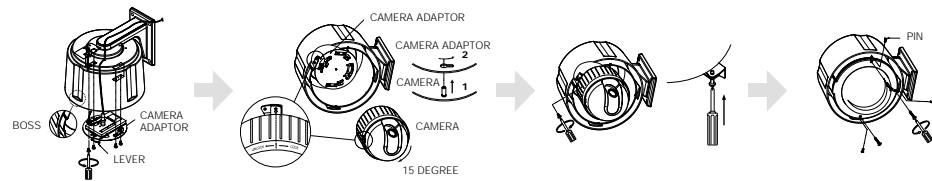

### SADT-100WM/101WM

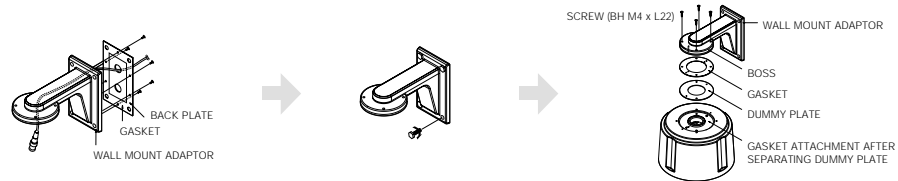

### SADT-100PM

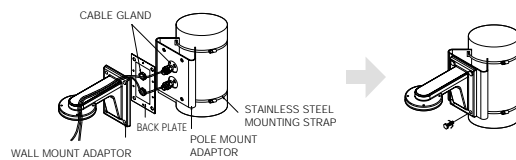

### SADT-110CM

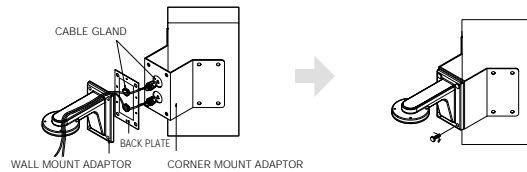

### SADT-100CM

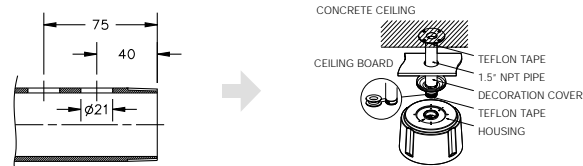

### SBR-100DCM

